

R11-3aMOD;
 1.9" Radius, 0.8" Border, 0.5" Indent, Black on White;
 "ROAD", C 2K specified length; "CLOSED", C 2K;
 "1.0 MILES AHEAD", C 2K;
 "LOCAL TRAFFIC ONLY", C 2K;

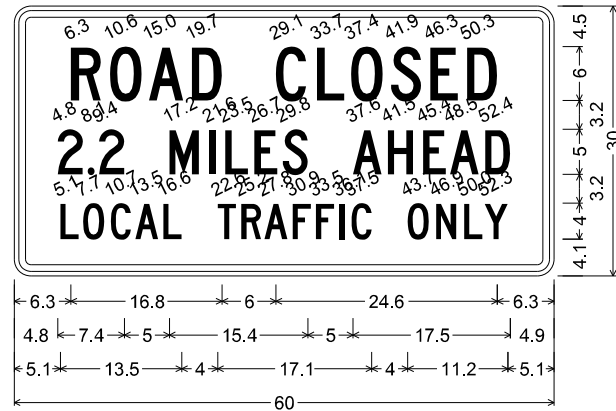

R11-3aMOD;
 1.9" Radius, 0.8" Border, 0.5" Indent, Black on White;
 "ROAD", C 2K specified length; "CLOSED", C 2K;
 "2.2 MILES AHEAD", C 2K;
 "LOCAL TRAFFIC ONLY", C 2K;

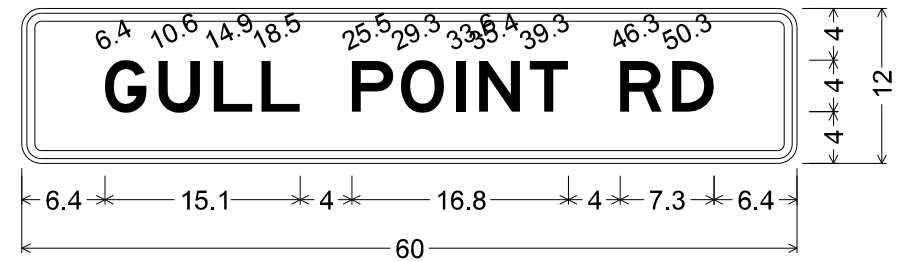

1.5" Radius, 0.6" Border, 0.4" Indent, Black on Orange;
 "GULL POINT RD", E 2K;

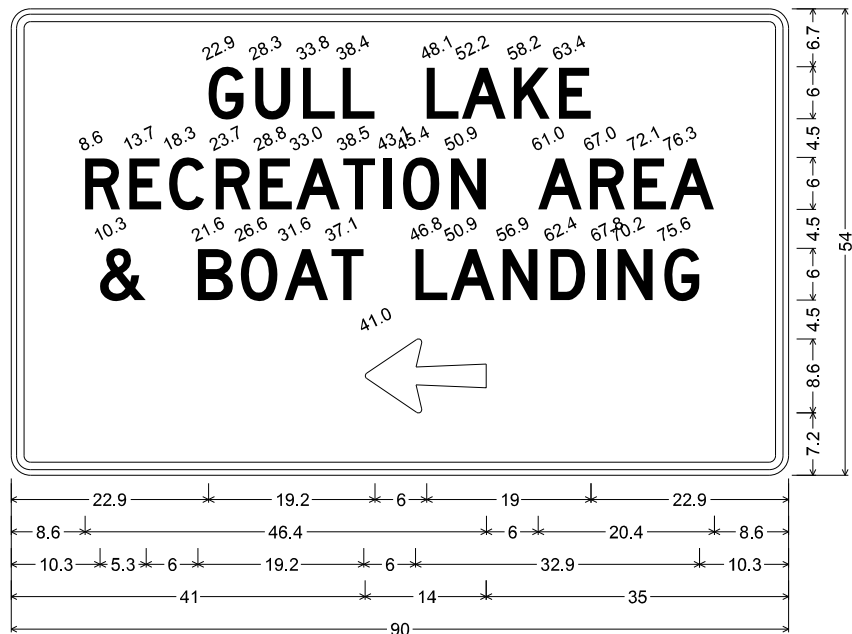

BUSINESS ACCESS LT ARROW;
 2.3" Radius, 0.9" Border, 0.6" Indent, Black on Orange;
 "GULL LAKE", D 2K; "RECREATION AREA", D 2K; "& BOAT LANDING", D 2K;
 "", D 2K; Arrow 13 - 14.0" 180°;

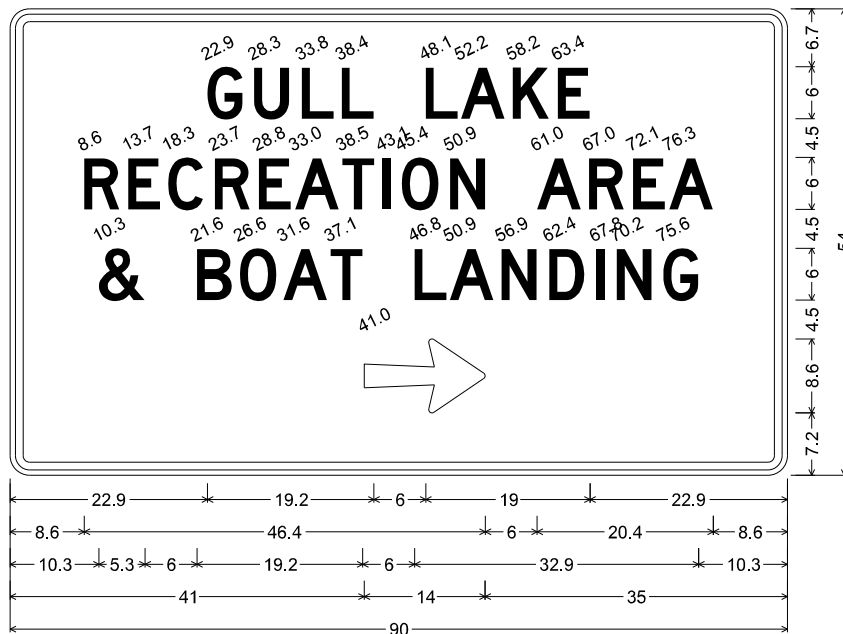

BUSINESS ACCESS LT ARROW;
 2.3" Radius, 0.9" Border, 0.6" Indent, Black on Orange;
 "GULL LAKE", D 2K; "RECREATION AREA", D 2K; "& BOAT LANDING", D 2K;
 "", D 2K; Arrow 13 - 14.0" 0°;

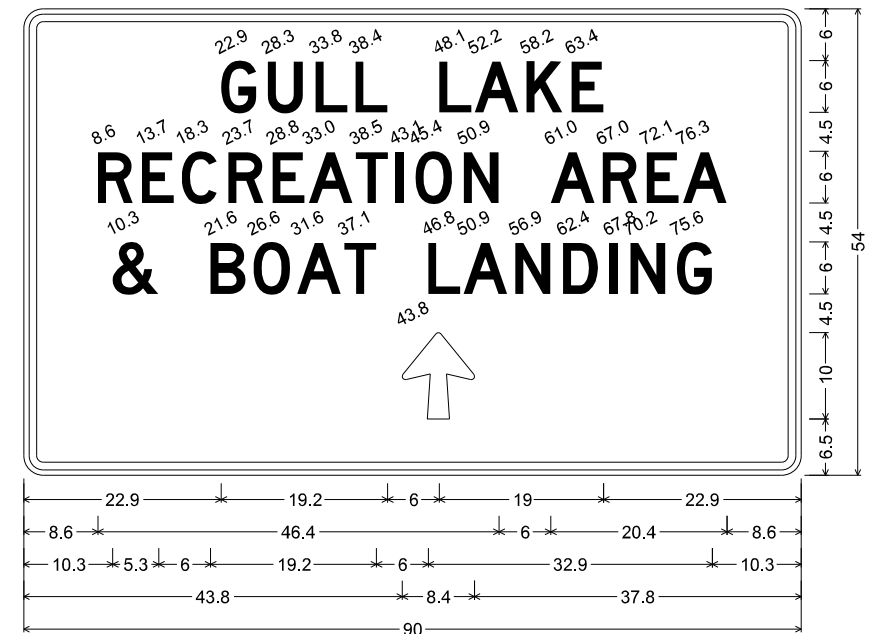

BUSINESS ACCESS LT ARROW;
 2.3" Radius, 0.9" Border, 0.6" Indent, Black on Orange;
 "GULL LAKE", D 2K; "RECREATION AREA", D 2K; "& BOAT LANDING", D 2K;
 "", D 2K; Arrow 3 - 10.0" 90°;

NOTE:
 1. ALL SIGN DEMENSIONS IN INCHES.
 2. SEE STANDARD SIGNS MANUAL FOR ROUTE MARKER DETAILS.

STAGE 2
TRAFFIC
 CLOSE A SECTION OF GULL LAKE DAM RD (OLD CR 105) JUST EAST OF GULL POINT ROAD TO CONSTRUCT THE NORTH ROUNDABOUT.
 DETOUR EB AND WB GULL LAKE DAM ROAD (OLD CR 105) THROUGH POPLAR DRIVE.

CONSTRUCTION
 CONSTRUCT THE NORTH ROUNDABOUT CIRCULATORY ROADWAY, EAST LEG CONNECTION, AND PARTIAL NORTH LEG CONNECTION.

STAGE 2A
TRAFFIC
 OPEN THE NORTH ROUNDABOUT FOR WESTBOUND TO SOUTHBOUND TRAFFIC.
 OPEN THE SOUTH ROUNDABOUT TO TRAFFIC.

CONSTRUCTION
 CONSTRUCT THE NORTH LEG OF THE NORTH ROUNDABOUT AND CLOSE ACCESS TO THE WEST LEG OF GULL LAKE DAM ROAD AND GULL POINT ROAD.

SEE SHEET 137 FOR INTERSECTION SIGNING

SEE SHEET 136 FOR INTERSECTION SIGNING

SEE SHEET 138 FOR INTERSECTION SIGNING

GENERAL NOTES:

- ALL TRAFFIC CONTROL DEVICES SHALL CONFORM AND BE PLACED IN ACCORDANCE WITH THE CURRENT "MINNESOTA MANUAL ON UNIFORM TRAFFIC CONTROL DEVICES" (MN MUTCD) AND PART VI, "FIELD MANUAL FOR TEMPORARY TRAFFIC CONTROL ZONE LAYOUTS".
- ENSURE A MINIMUM OF 300' SEPARATION BETWEEN EXISTING AND PROPOSED SIGNS IN RURAL AREAS AND A MINIMUM OF 100' SEPARATION BETWEEN SIGNS IN URBAN AREAS.

LEGEND

— DETOUR ROUTE

▨ CONSTRUCTION ZONE

② INPLACE SIGN

SPECIFIC NOTES:
 ② INPLACE SIGN

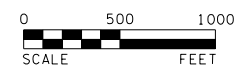

REV. BY DATE

I HEREBY CERTIFY THAT THIS PLAN, SPECIFICATION, OR REPORT WAS PREPARED BY ME OR UNDER MY DIRECT SUPERVISION AND THAT I AM A DULY LICENSED PROFESSIONAL ENGINEER UNDER THE LAWS OF THE STATE OF MINNESOTA.

DARWIN YASIS
 LIC. NO. 45469 DATE 04-11-2023

DESIGNED TOD
 DRAWN SN
 CHECKED DY

S.P. 011-670-004, S.A.P. 011-670-009
 C.S.A.H. 70 RECONSTRUCTION
 STAGING & TRAFFIC CONTROL PLAN
 DETOUR PLAN - STAGE 2

SHEET 131 OF 142

tcooke 8/29/2024 pdf-B and W.pltcfgr bmi.tbl 11:27:21 AM